



advance



Made In The U.S.A.

DA-LITE SCREEN COMPANY, INC.

3100 North Detroit Street

Post Office Box 137

Warsaw, IN 46581-0137

Phone: 574-267-8101

800-622-3737

Fax: 574-267-7804

877-325-4832

www.da-lite.com

info@da-lite.com

Pivoting Da-Lift Plenum Cover 26P and 33P

Form E-454
Rev. 08 / 10

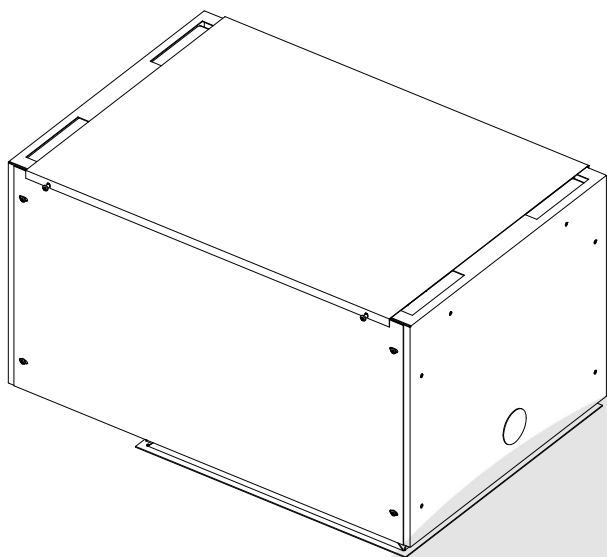

Caution: This product is designed for ceiling installation only. Qualified personnel using the appropriate fasteners should mount the Pivoting Da-Lift and Plenum Cover. The surface to which this unit is mounted must be capable of supporting a static load of four times the combined weight of the projector and mount. Do not attach to plaster or drywall alone.

IMPORTANT SAFETY INSTRUCTIONS

When using your video equipment, basic safety precautions should always be followed, including the following:

1. Read and understand all instructions before using.
2. Position the cord so that it will not be tripped over, pulled, or contact hot surfaces.
3. If an extension cord is necessary, a cord with a current rating at least equal to that of the appliance should be used. Cords rated for less amperage than the appliance may overheat.
4. To reduce the risk of electric shock, do not disassemble this appliance. Contact an authorized service dealer when repair work is required. Incorrect reassembly can cause electric shock when the appliance is used subsequently.
5. The use of an accessory attachment not recommended by the manufacturer may cause a risk of fire, electric shock, or injury to persons.

IMPORTANT INSTALLATION NOTES

If Pivoting Da-Lift is installed in "other space used for environmental air", a plenum cover must be installed.

Suitable for Use in Other Environmental Air Space in Accordance with Section 300.22(c) of the National Electrical Code, and Sections 2-128, 12-010(3) and 12-100 of the Canadian Electrical Code, Part 1, CSA C22.1.

SAVE THESE INSTRUCTIONS

Required Tools:

- Phillips screwdriver

Procedure

1. Remove contents from carton and examine for damaged or missing parts.

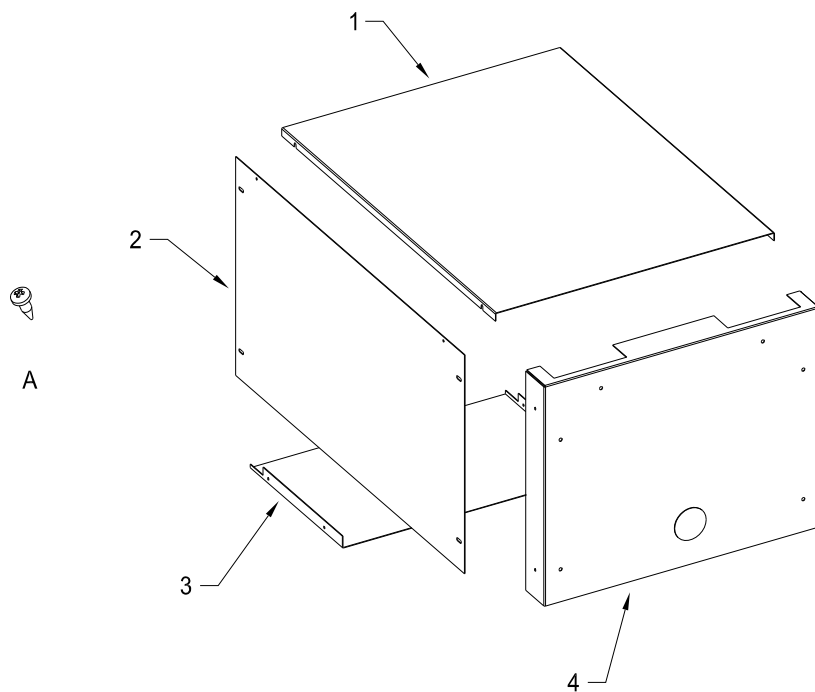

ITEM	DESCRIPTION	QTY
1	PLENUM COVER, TOP	1
2	PLENUM COVER, SIDE	2
3	PLENUM COVER, BOTTOM	1
4	PLENUM COVER, END	1
	PACKAGE SET	1
A	SCREW, SHEET METAL, #8-1/2"	16

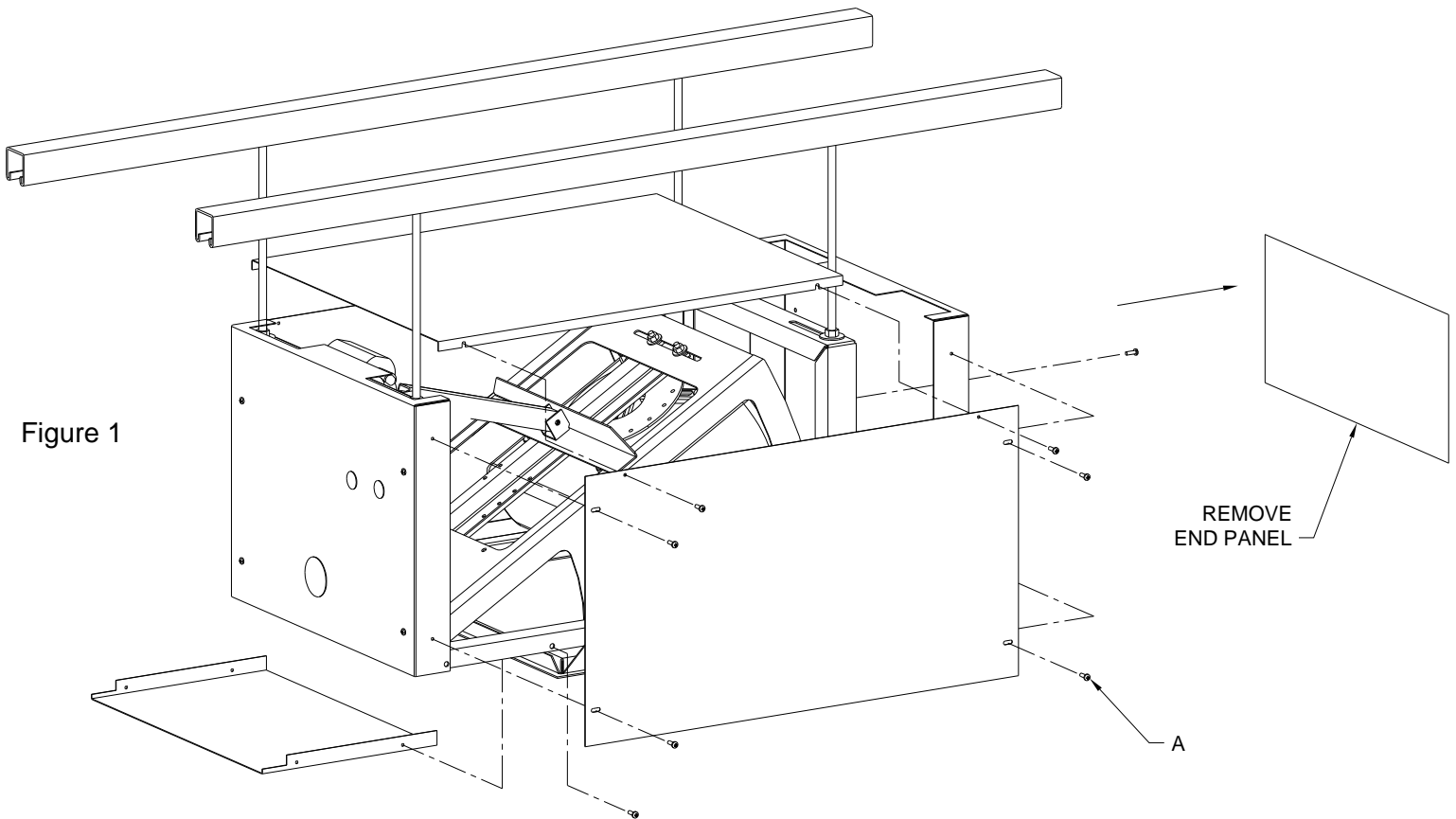

Figure 1

2. Install Plenum Cover Bottom first. See Figure 1.
3. Remove end panel from Da-Lift. The end panel may be discarded but save the fasteners.
4. Secure the Plenum Cover End to the Da-Lift using the fasteners from step 3.
5. Secure both Plenum Cover Sides to the Da-Lift.
6. Secure the Plenum Cover Top to the Plenum Cover Sides.